

7,508 SF - Available For Lease

2 Barnes Industrial Road South | Wallingford, Connecticut



For more information or to schedule a tour of the property, please contact:

Timothy Fegan
203.777.5991
timothy.fegan@cbre-ne.com

Matthew O'Hare
203.777.5990
matthew.ohare@cbre-ne.com

David Hansen
203.777.5996
david.hansen@cbre-ne.com

One Century Tower, 10th Floor
265 Church Street, Suite 1008
New Haven, Connecticut 06510
203.777.6262 Fax 203.777.5995
www.cbre.com/newhaven

CBRE | New England
CB RICHARD ELLIS

2 Barnes Industrial Road South is conveniently located to Interstate 91, Exit 15 and the Wilbur Cross Parkway, Exit 66. The site is ideal for companies seeking **high image space**.

Building Specifications

Building Size:	41,902 SF
Available Space:	7,508 SF
Year Built:	1976
Type:	Office/flex
Floors:	1
Office Area:	Build-to-suit
Ceiling Height:	14' clear
Air Conditioning:	100%
Column Spacing:	30' x 40'
Construction:	Block
Land:	8 Acres
Power:	1,200 amp/480 volts/3 phase
Parking:	160 spaces
Location:	Convenient to I-91 and Route 15 (Wilbur Cross Parkway)

This 41,902 SF building has recently been renovated to include:

- New windows and entrances
- New outdoor lighting
- Landscaped improvements
- Parking lot expansion and improvement
- New 1,200 amp services

©2005 CB Richard Ellis Inc. All rights reserved. We obtained the information above from sources we believe to be reliable. However, we have not verified its accuracy and make no guarantee, warranty or representation about it. It is submitted subject to the possibility of errors, omissions, change of price, rental or other conditions, prior sale, lease or financing, or withdrawal without notice. We include projections, opinions, assumptions or estimates for example only, and they may not represent current or future performance of the property. You and your tax and legal advisors should conduct your own investigation of the property and transaction.

2 Barnes Industrial Road South | Wallingford, Connecticut

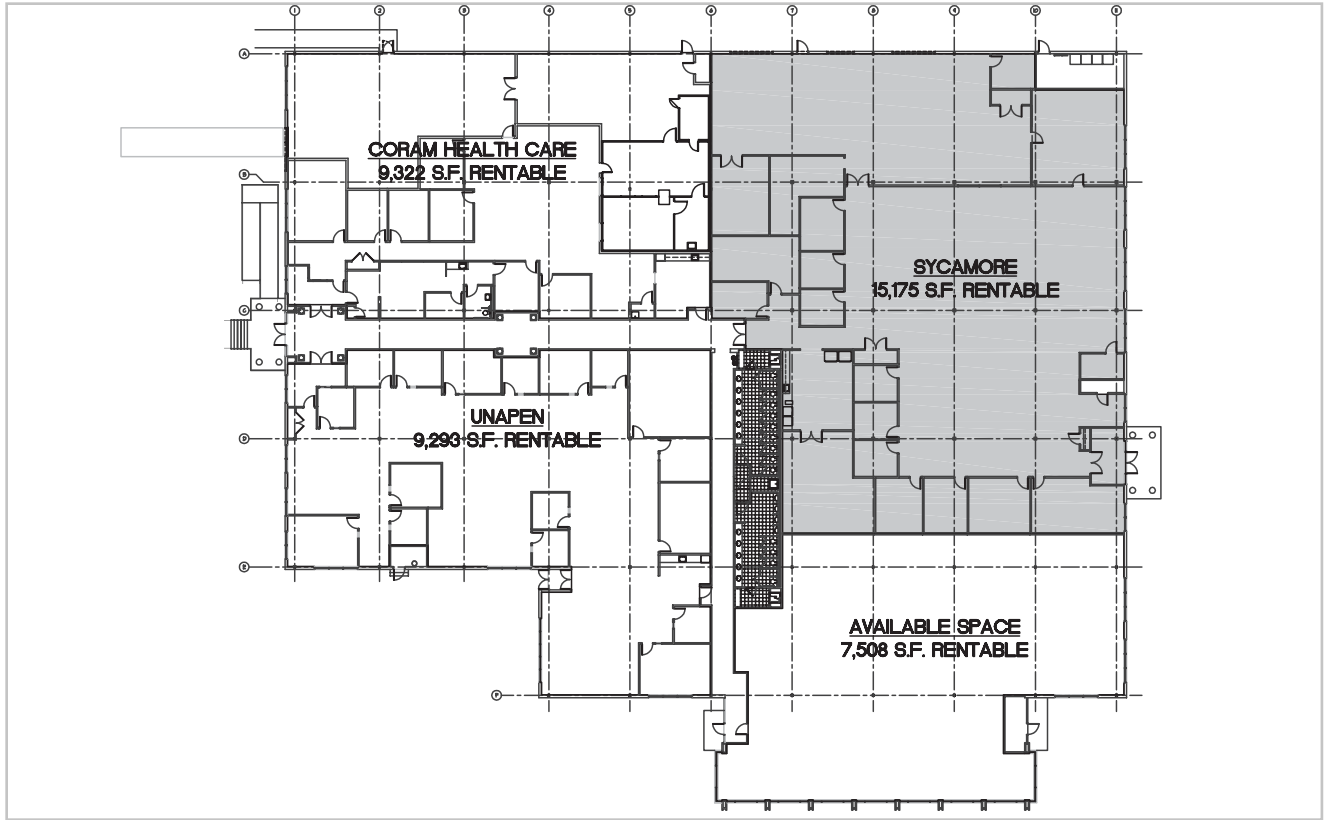

Floor Plan

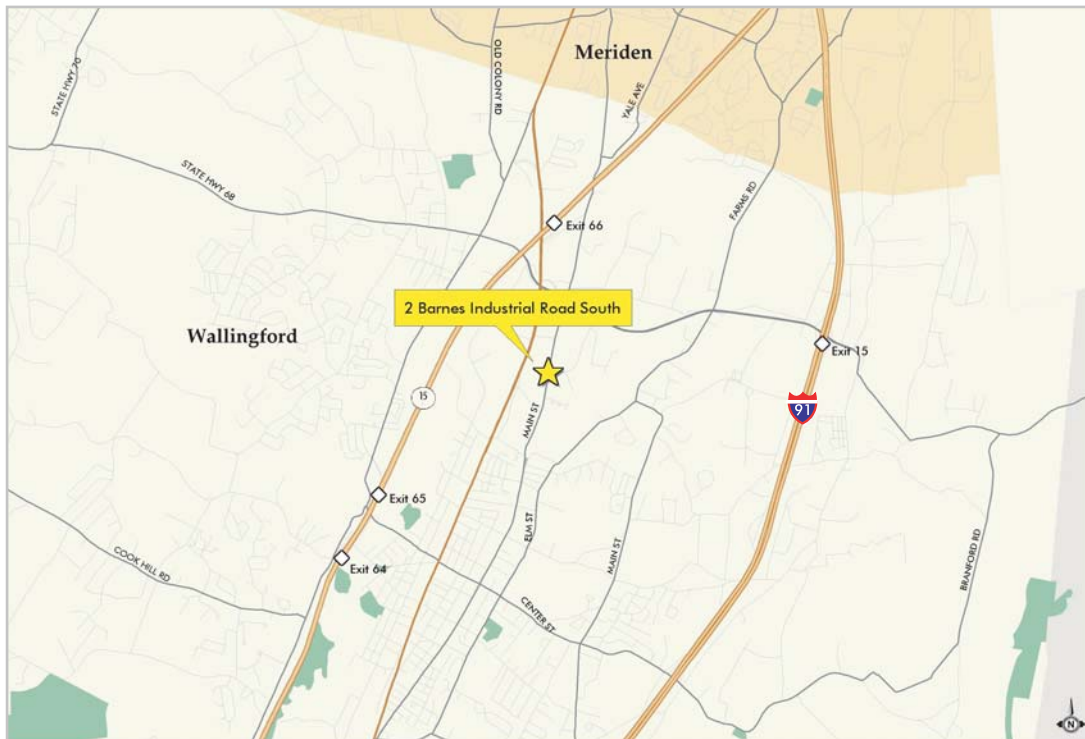

For more information or a tour of the property, please contact:

Timothy Fegan
203.777.5991
timothy.fegan@cbre-ne.com

Matthew O'Hare
203.777.5990
matthew.ohare@cbre-ne.com

David Hansen
203.777.5996
david.hansen@cbre-ne.com

